

4

3

2

1

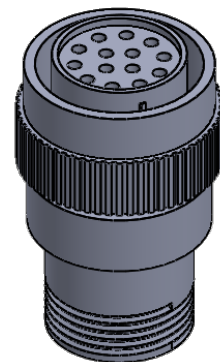
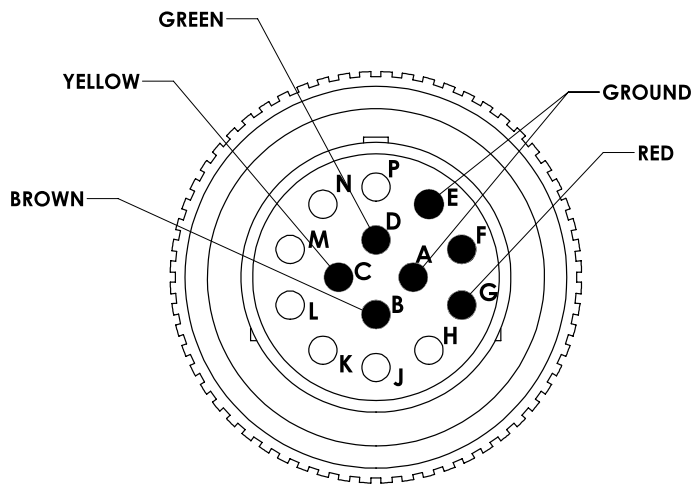
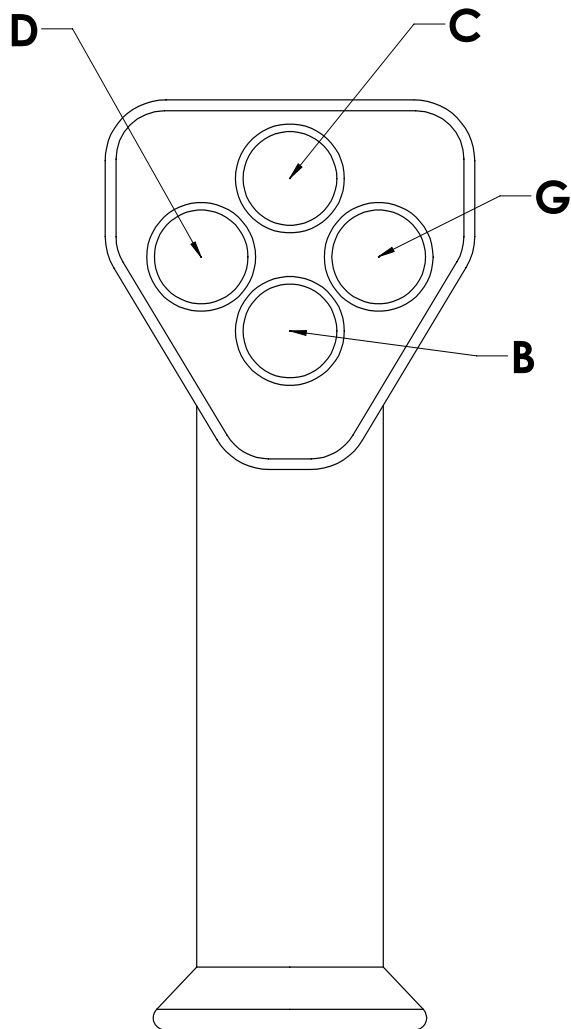

PIN	COLOR
A	GROUND
B	BROWN
C	YELLOW
D	GREEN
E	GROUND
G	RED

<b>DIMENSIONS ARE IN INCHES</b>		DRAWN BY	DATE	DESCRIPTION	
UNLESS OTHERWISE SPECIFIED, TOLERANCES ARE: ONE PLACE (X.X) = ± 0.060 TWO PLACE (X.XX) = ± 0.020 THREE PLACE (X.XXX) = ± 0.005 ANGULAR = ± 1°					ASV Skid Steer
 2190 Pequea Lane Lancaster, PA 17602 717.405.7785 Office 717.983.4669 Fax www.roadrunnerblade.com		VENDOR		SIZE	
		<b>PROPRIETARY AND CONFIDENTIAL</b> THE INFORMATION CONTAINED IN THIS DRAWING IS THE SOLE PROPERTY OF ROADRUNNER EQUIPMENT. ANY REPRODUCTION IN PART OR AS A WHOLE WITHOUT WRITTEN PERMISSION IS PROHIBITED.		MATERIAL MATERIAL <NOT SPECIFIED>	
		WEIGHT (LBS) 0.72		B Wiring, Joystick, ASV SCALE:1:1	REV.
				SHEET 1 OF 1	

4

3

2

1

4

3

2

1

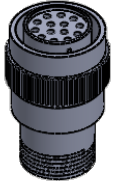
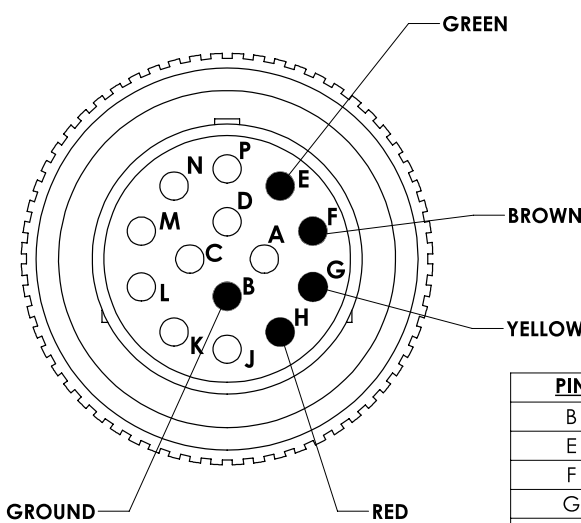
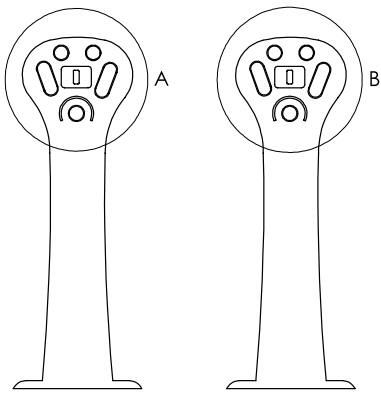

PIN	COLOR
B	WHITE (GROUND)
E	GREEN
F	BROWN
G	YELLOW
H	RED

NOTE:  
7 pin to 14 pin controller  
adapter needed.

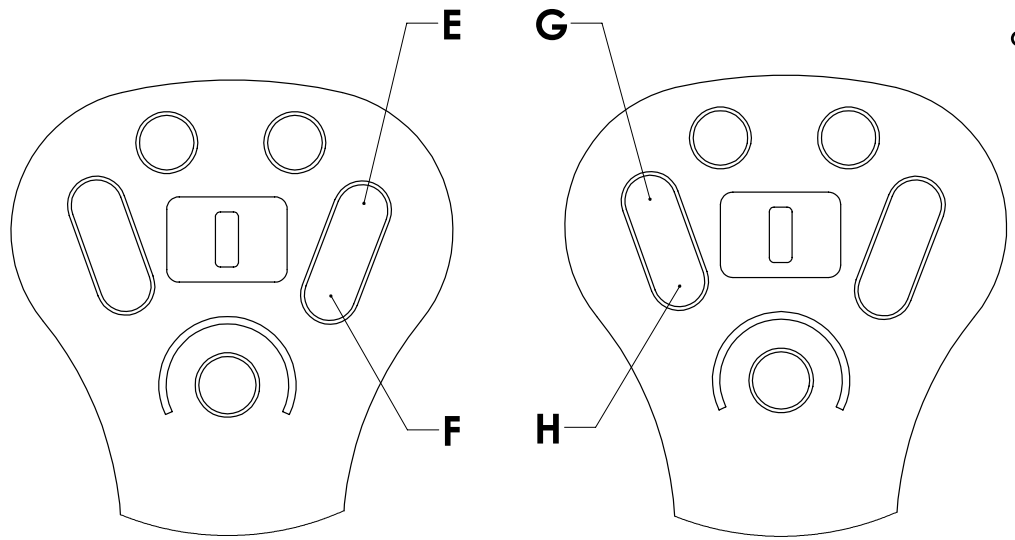

4

3

2

1

**ROADRUNNER**  
EQUIPMENT LLC.  
2190 Pequea Lane 717.405.7785 Office  
Lancaster, PA 17602 717.983.4669 Fax  
www.roadrunnerblade.com

<b>DIMENSIONS ARE IN INCHES</b>		DRAWN BY	DATE	DESCRIPTION
UNLESS OTHERWISE SPECIFIED, TOLERANCES ARE: ONE PLACE (X.X) = ± 0.060 TWO PLACE (X.XX) = ± 0.020 THREE PLACE (X.XXX) = ± 0.005 ANGULAR = ± 1°				
<b>PROPRIETARY AND CONFIDENTIAL</b> THE INFORMATION CONTAINED IN THIS DRAWING IS THE SOLE PROPERTY OF ROADRUNNER EQUIPMENT. ANY REPRODUCTION IN PART OR AS A WHOLE WITHOUT WRITTEN PERMISSION IS PROHIBITED.		MATERIAL MATERIAL <NOT SPECIFIED>		Bobcat Skid Steer
		WEIGHT (LBS) 2.23	SIZE <b>B</b>	
			PART NO. Wiring, Joystick, Bobcat	REV.
			SCALE: 1:4	SHEET 1 OF 1

4

3

2

1

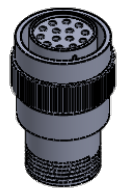
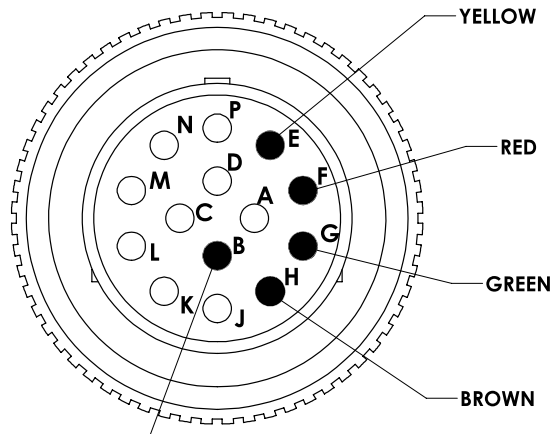
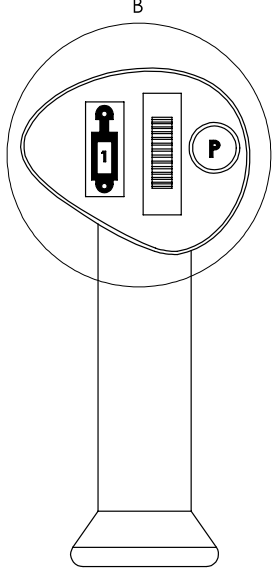
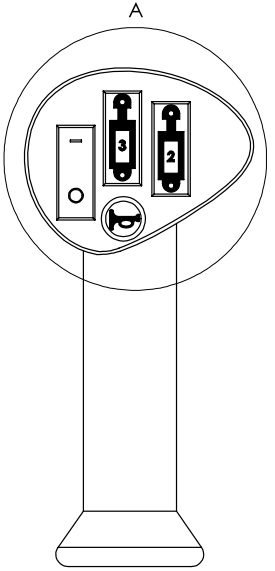

PIN	COLOR
B	WHITE (GROUND)
E	YELLOW
F	RED
G	GREEN
H	BROWN

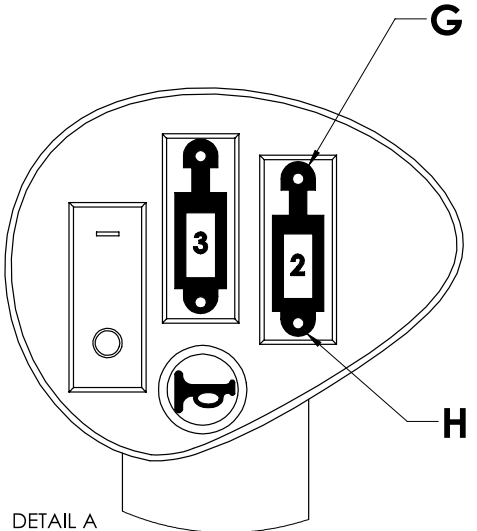

DETAIL A  
SCALE 1:1

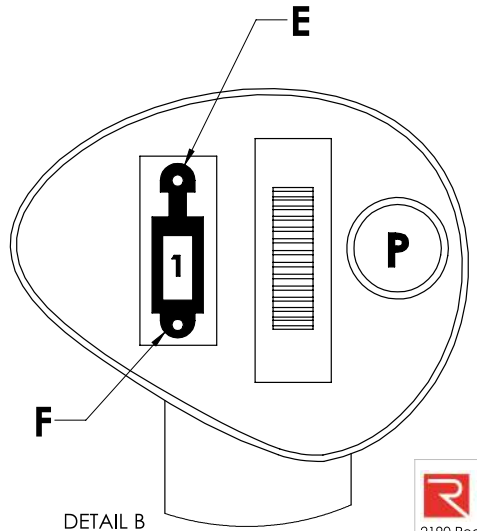

DETAIL B  
SCALE 1:1

**ROADRUNNER**  
EQUIPMENT LLC.  
2190 Pequea Lane 717.405.7785 Office  
Lancaster, PA 17602 717.983.4669 Fax  
www.roadrunnerblade.com

<b>DIMENSIONS ARE IN INCHES</b>		DRAWN BY	DATE	DESCRIPTION
UNLESS OTHERWISE SPECIFIED, TOLERANCES ARE: ONE PLACE (X.X) = ± 0.060 TWO PLACE (X.XX) = ± 0.020 THREE PLACE (X.XXX) = ± 0.005 ANGULAR = ± 1°				
<b>PROPRIETARY AND CONFIDENTIAL</b> THE INFORMATION CONTAINED IN THIS DRAWING IS THE SOLE PROPERTY OF ROADRUNNER EQUIPMENT. ANY REPRODUCTION IN PART OR AS A WHOLE WITHOUT WRITTEN PERMISSION IS PROHIBITED.		MATERIAL MATERIAL <NOT SPECIFIED>		SIZE <b>B</b>
		WEIGHT (LBS) 1.83		PART NO. Wiring, Joystick, Case
				SCALE: 1:2
				SHEET 1 OF 1

4

3

2

1

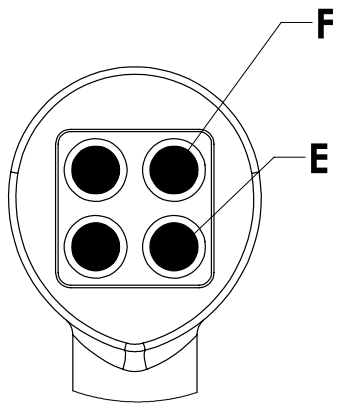
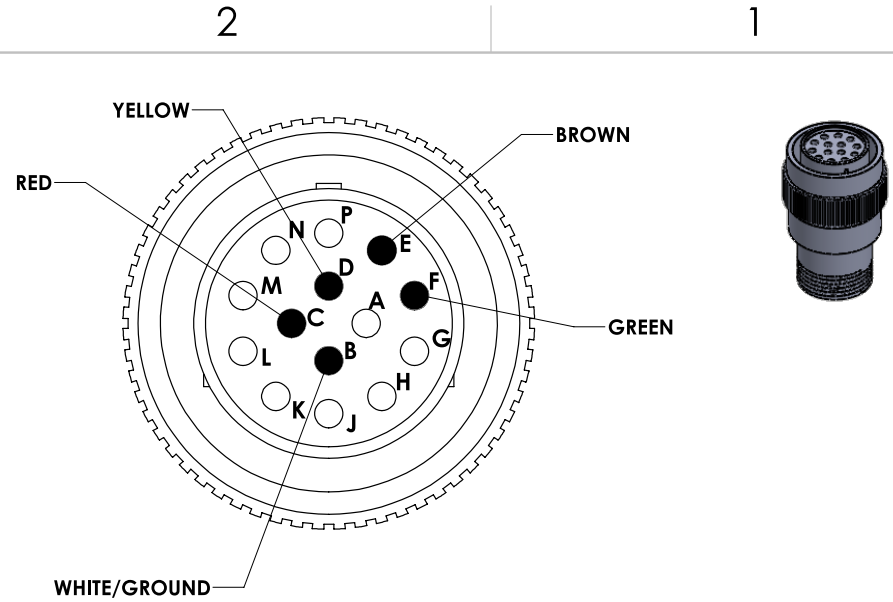
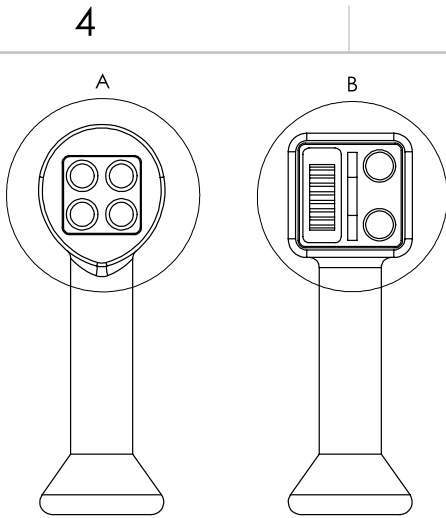

DETAIL A  
SCALE 1 : 1

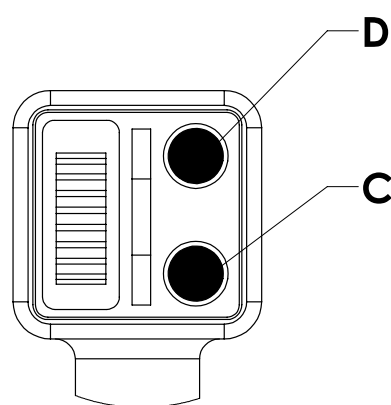

DETAIL B  
SCALE 1 : 1

PIN	COLOR
B	WHITE (GROUND)
C	RED
D	YELLOW
E	BROWN
F	GREEN

**ROADRUNNER**  
EQUIPMENT LLC.  
2190 Pequea Lane 717.405.7785 Office  
Lancaster, PA 17602 717.983.4669 Fax  
www.roadrunnerblade.com

DIMENSIONS ARE IN INCHES		DRAWN BY	DATE	DESCRIPTION
UNLESS OTHERWISE SPECIFIED, TOLERANCES ARE: ONE PLACE (X.X) = ± 0.060 TWO PLACE (X.XX) = ± 0.020 THREE PLACE (X.XXX) = ± 0.005 ANGULAR = ± 1°				CAT D-SERIES SKID STEER
<b>PROPRIETARY AND CONFIDENTIAL</b> THE INFORMATION CONTAINED IN THIS DRAWING IS THE SOLE PROPERTY OF ROADRUNNER EQUIPMENT. ANY REPRODUCTION IN PART OR AS A WHOLE WITHOUT WRITTEN PERMISSION IS PROHIBITED.		VENDOR		
		MATERIAL	MATERIAL <NOT SPECIFIED>	SIZE   PART NO.
		WEIGHT (LBS)	1.02	<b>B</b> Wiring, Joystick, CAT D-Series
		SCALE: 1:2		REV.
				SHEET 1 OF 1

4

3

2

1

B

B

A

A

4

3

2

1

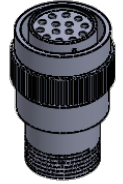
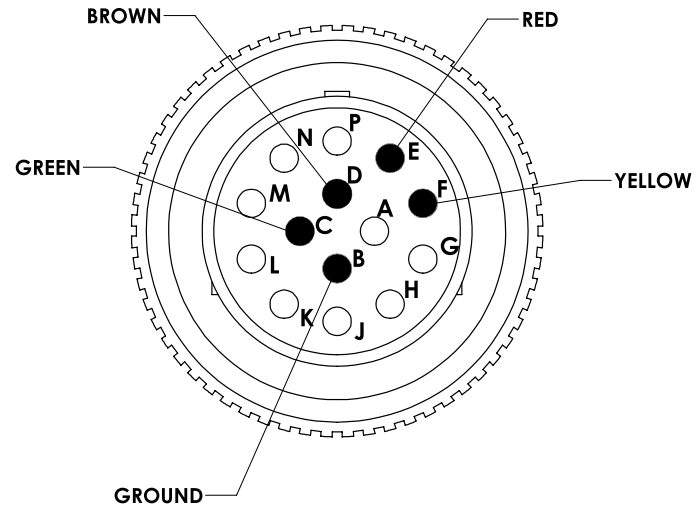
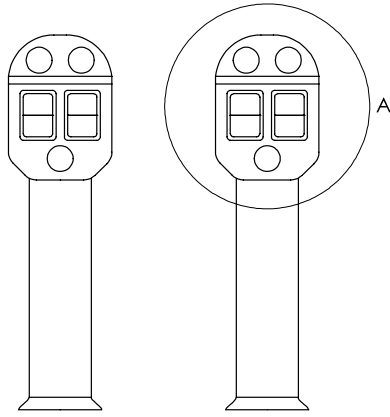

B

B

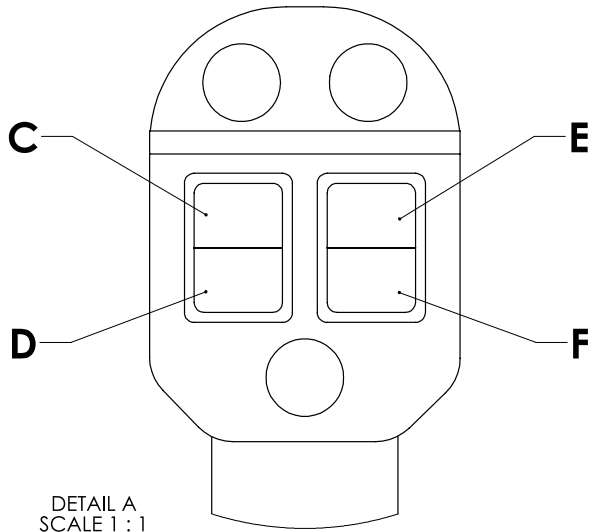

PIN	COLOR
B	WHITE (GROUND)
C	GREEN
D	BROWN
E	RED
F	YELLOW

DETAIL A  
SCALE 1 : 1

A

A

4

3

2

1

**ROADRUNNER EQUIPMENT LLC.**  
 2190 Pequea Lane 717.405.7785 Office  
 Lancaster, PA 17602 717.983.4669 Fax  
 www.roadrunnerblade.com

<b>DIMENSIONS ARE IN INCHES</b>		DRAWN BY	DATE	DESCRIPTION	
UNLESS OTHERWISE SPECIFIED, TOLERANCES ARE: ONE PLACE (X.X) = ± 0.060 TWO PLACE (X.XX) = ± 0.020 THREE PLACE (X.XXX) = ± 0.005 ANGULAR = ± 1°					JCB/ Volvo Skid Steer
<b>PROPRIETARY AND CONFIDENTIAL</b> THE INFORMATION CONTAINED IN THIS DRAWING IS THE SOLE PROPERTY OF ROADRUNNER EQUIPMENT. ANY REPRODUCTION IN PART OR AS A WHOLE WITHOUT WRITTEN PERMISSION IS PROHIBITED.		VENDOR		SIZE   PART NO.   REV. <b>B</b> Wiring, Joystick, JCB_Volvo	
		MATERIAL MATERIAL <NOT SPECIFIED>	WEIGHT (LBS) 1.90	SCALE: 1:3	SHEET 1 OF 1

4

3

2

1

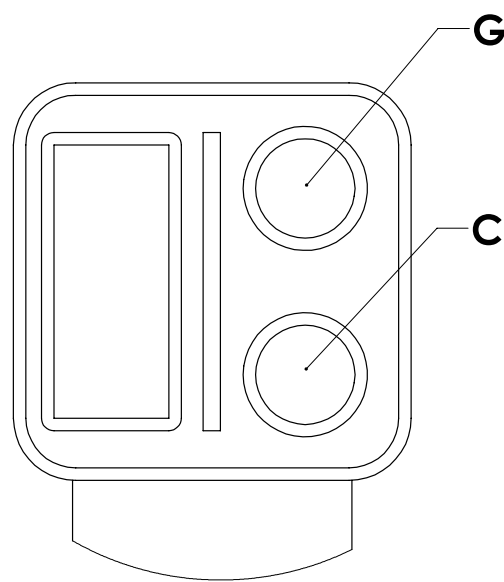
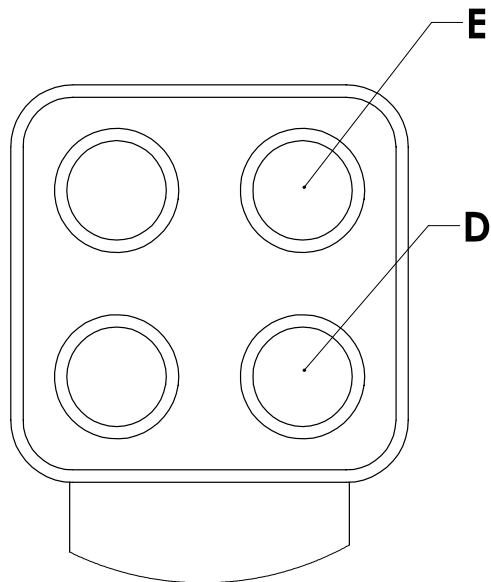
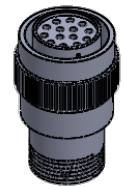
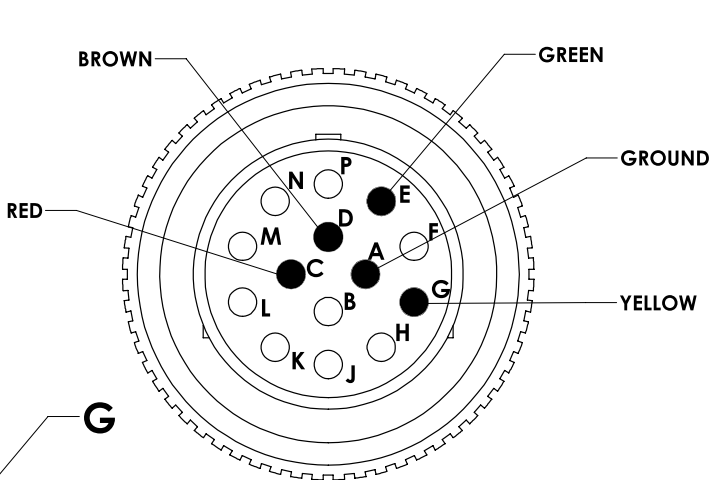
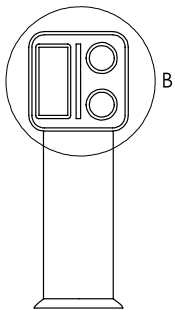
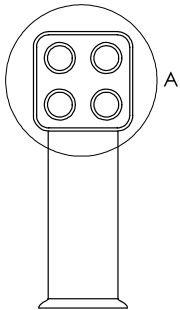

PIN	COLOR
A	WHITE (GROUND)
C	RED
D	BROWN
E	GREEN
G	YELLOW

<b>DIMENSIONS ARE IN INCHES</b>		DRAWN BY	DATE	DESCRIPTION
UNLESS OTHERWISE SPECIFIED, TOLERANCES ARE: ONE PLACE (X.X) = ± 0.060 TWO PLACE (X.XX) = ± 0.020 THREE PLACE (X.XXX) = ± 0.005 ANGULAR = ± 1°				
<b>ROADRUNNER EQUIPMENT LLC.</b> 2190 Pequea Lane Lancaster, PA 17602 717.405.7785 Office 717.983.4669 Fax www.roadrunnerblade.com		VENDOR		John Deere Skid Steer
		MATERIAL MATERIAL <NOT SPECIFIED>		SIZE   PART NO. <b>BWiring, Joystick, John Deere</b>
<b>PROPRIETARY AND CONFIDENTIAL</b> THE INFORMATION CONTAINED IN THIS DRAWING IS THE SOLE PROPERTY OF ROADRUNNER EQUIPMENT. ANY REPRODUCTION IN PART OR AS A WHOLE WITHOUT WRITTEN PERMISSION IS PROHIBITED.		WEIGHT (LBS) 3.75	SCALE:1:4	SHEET 1 OF 1

4

3

2

1

4

3

2

1

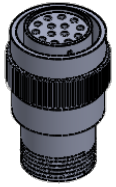
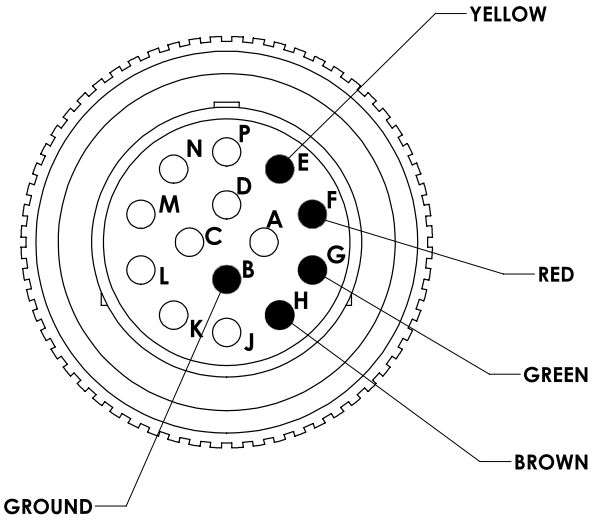
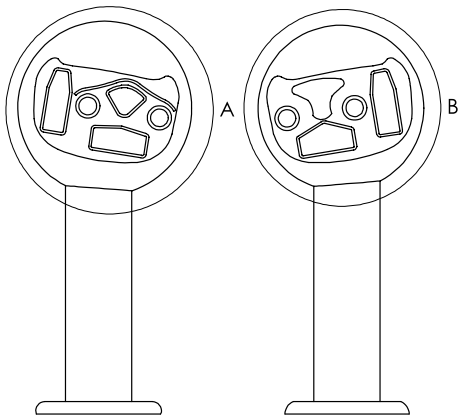

PIN	COLOR
B	WHITE (GROUND)
E	YELLOW
F	RED
G	GREEN
H	BROWN

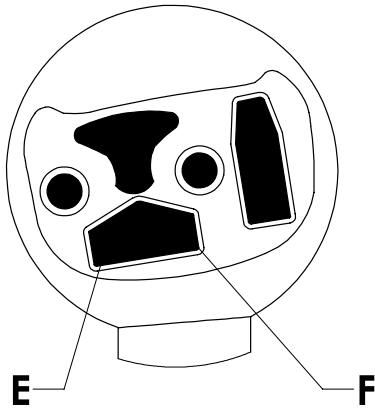
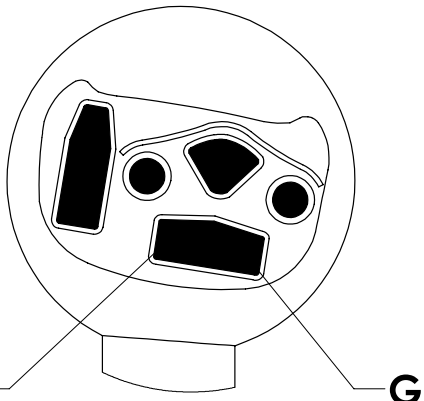

<p><b>DIMENSIONS ARE IN INCHES</b></p> <p>UNLESS OTHERWISE SPECIFIED, TOLERANCES ARE:</p> <p>ONE PLACE (X.X) = ± 0.060</p> <p>TWO PLACE (X.XX) = ± 0.020</p> <p>THREE PLACE (X.XXX) = ± 0.005</p> <p>ANGULAR = ± 1°</p>	DRAWN BY	DATE	DESCRIPTION		
	VENDOR			<p>Kubota Skid Steer</p>	
<p><b>PROPRIETARY AND CONFIDENTIAL</b></p> <p>THE INFORMATION CONTAINED IN THIS DRAWING IS THE SOLE PROPERTY OF ROADRUNNER EQUIPMENT. ANY REPRODUCTION IN PART OR AS A WHOLE WITHOUT WRITTEN PERMISSION IS PROHIBITED.</p>	MATERIAL	SIZE	PART NO.		REV.
	MATERIAL <NOT SPECIFIED>	WEIGHT (LBS)	B	Wiring, Joystick, Kubota	
<p>2190 Pequea Lane 717.405.7785 Office</p> <p>Lancaster, PA 17602 717.983.4669 Fax</p> <p>www.roadrunnerblade.com</p>	2.51	SCALE:1:3		SHEET 1 OF 1	

4

3

2

1

B

B

A

A

4

3

2

1

A

B

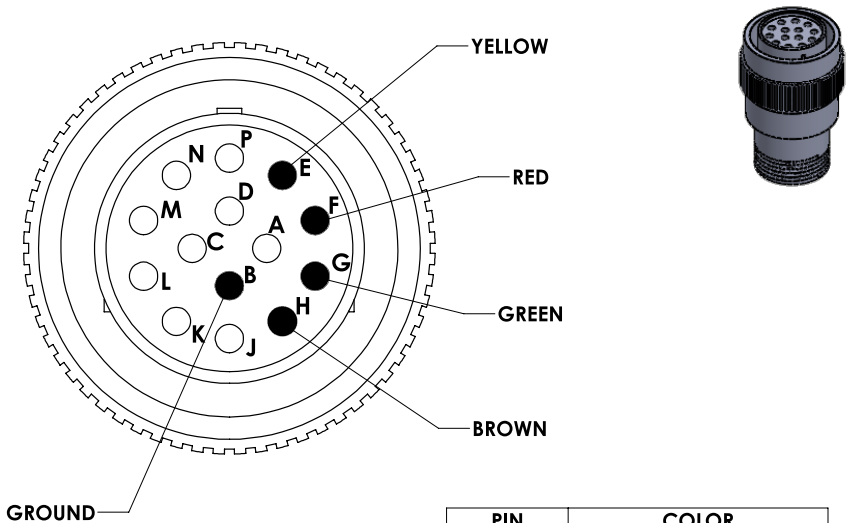
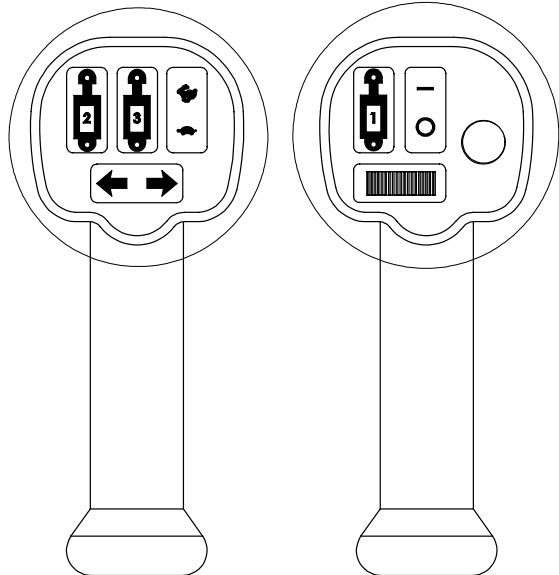

PIN	COLOR
B	WHITE (GROUND)
E	YELLOW
F	RED
G	GREEN
H	BROWN

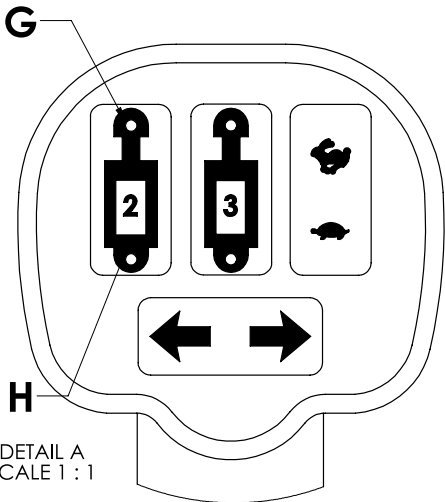

DETAIL A  
SCALE 1:1

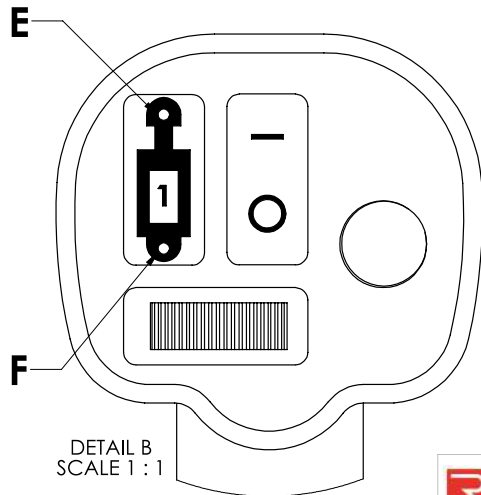

DETAIL B  
SCALE 1:1

**ROADRUNNER**  
EQUIPMENT LLC.  
2190 Pequea Lane 717.405.7785 Office  
Lancaster, PA 17602 717.983.4669 Fax  
www.roadrunnerblade.com

DIMENSIONS ARE IN INCHES		DRAWN BY	DATE	DESCRIPTION
UNLESS OTHERWISE SPECIFIED, TOLERANCES ARE:				New Holland Skid Steer
ONE PLACE (X.X) = ± 0.060				
TWO PLACE (X.XX) = ± 0.020				
THREE PLACE (X.XXX) = ± 0.005				
ANGULAR = ± 1°				
VENDOR				
MATERIAL				
MATERIAL <NOT SPECIFIED>				
WEIGHT (LBS)				
2.07				
SIZE	PART NO.			REV.
	BWiring, Joystick, New Holland			
SCALE:1:2			SHEET 1 OF 1	

4

3

2

1

B

A



4

3

2

1

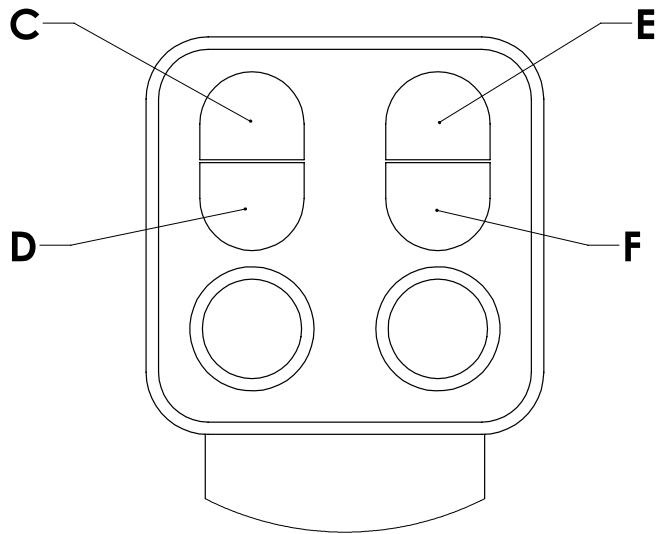
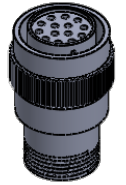
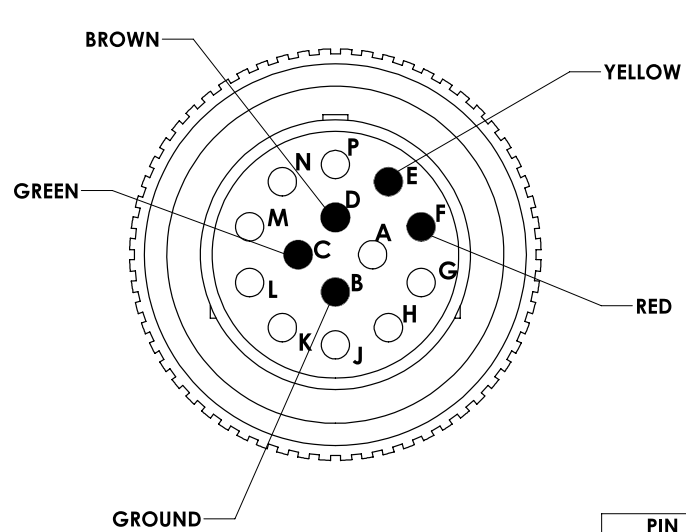
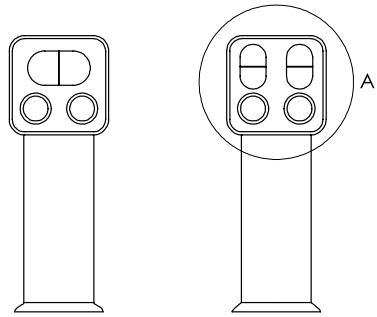

PIN	COLOR
B	WHITE (GROUND)
C	GREEN
D	BROWN
E	YELLOW
F	RED

**ROADRUNNER**  
EQUIPMENT LLC.  
2190 Pequea Lane 717.405.7785 Office  
Lancaster, PA 17602 717.983.4669 Fax  
www.roadrunnerblade.com

<p><b>DIMENSIONS ARE IN INCHES</b> UNLESS OTHERWISE SPECIFIED, TOLERANCES ARE: ONE PLACE (X.X) = ± 0.060 TWO PLACE (X.XX) = ± 0.020 THREE PLACE (X.XXX) = ± 0.005 ANGULAR = ± 1°</p>	DRAWN BY	DATE	DESCRIPTION
	VENDOR		
<p><b>PROPRIETARY AND CONFIDENTIAL</b> THE INFORMATION CONTAINED IN THIS DRAWING IS THE SOLE PROPERTY OF ROADRUNNER EQUIPMENT. ANY REPRODUCTION IN PART OR AS A WHOLE WITHOUT WRITTEN PERMISSION IS PROHIBITED.</p>	MATERIAL	MATERIAL <NOT SPECIFIED>	SIZE   PART NO.
	WEIGHT (LBS)	3.70	<p><b>B</b> Wiring, Joystick, Takeuchi</p>
SCALE: 1:4			SHEET 1 OF 1

4

3

2

1

4

3

2

1

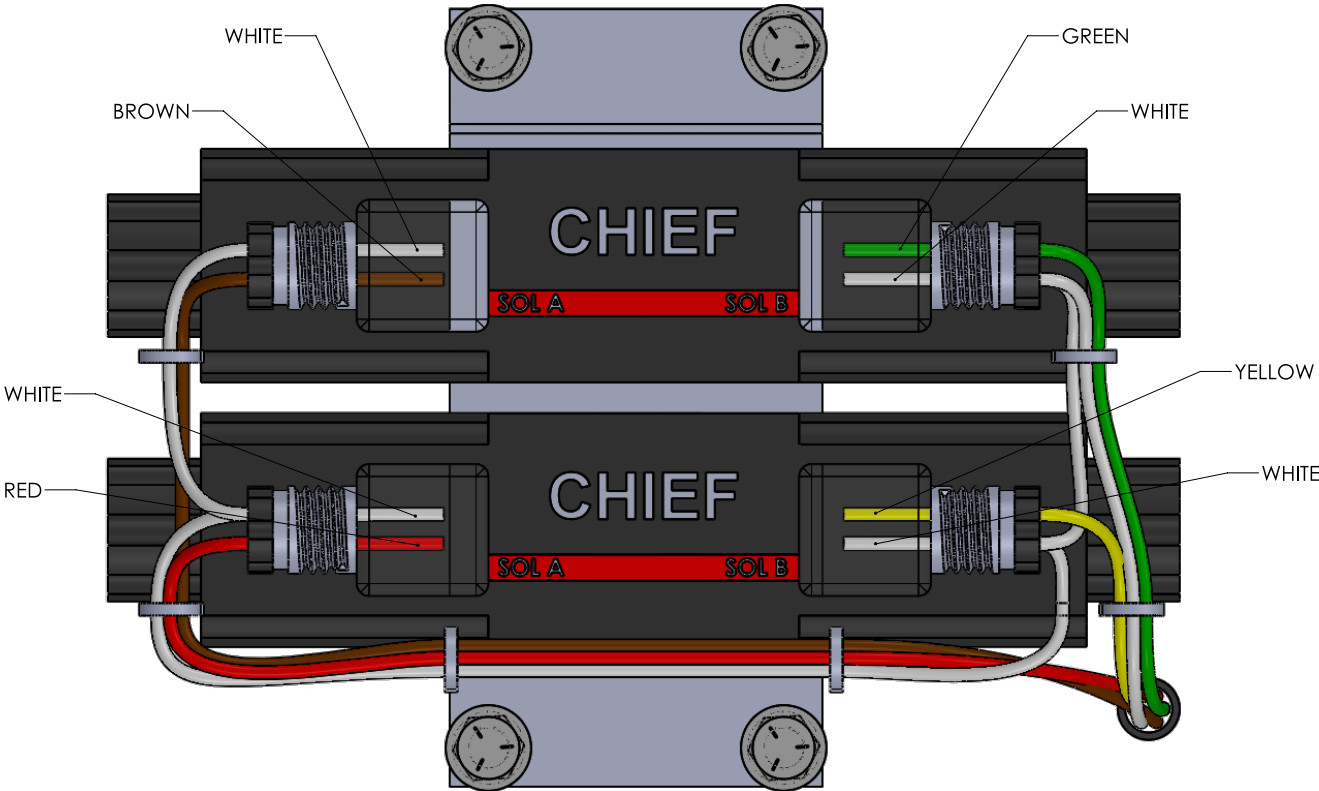

B

B

A

A

4

3

2

1

**ROADRUNNER**  
EQUIPMENT LLC.  
2190 Pequea Lane 717.405.7785 Office  
Lancaster, PA 17602 717.983.4669 Fax  
www.roadrunnerblade.com

<b>DIMENSIONS ARE IN INCHES</b>		DRAWN BY	DATE	DESCRIPTION
UNLESS OTHERWISE SPECIFIED, TOLERANCES ARE: ONE PLACE (X.X) = ± 0.060 TWO PLACE (X.XX) = ± 0.020 THREE PLACE (X.XXX) = ± 0.005 ANGULAR = ± 1°				
<b>PROPRIETARY AND CONFIDENTIAL</b> THE INFORMATION CONTAINED IN THIS DRAWING IS THE SOLE PROPERTY OF ROADRUNNER EQUIPMENT. ANY REPRODUCTION IN PART OR AS A WHOLE WITHOUT WRITTEN PERMISSION IS PROHIBITED.		VENDOR		SIZE
		MATERIAL		PART NO.
		WEIGHT (LBS)	3.49	<b>B</b> Wiring, Valve Assembly
				SCALE: 1:1
				SHEET 1 OF 2

4

3

2

1



B

B

A

A

4

3

2

1

**ROADRUNNER**  
EQUIPMENT LLC.  
2190 Pequea Lane 717.405.7785 Office  
Lancaster, PA 17602 717.983.4669 Fax  
www.roadrunnerblade.com

<b>DIMENSIONS ARE IN INCHES</b>		DRAWN BY	DATE	DESCRIPTION
UNLESS OTHERWISE SPECIFIED, TOLERANCES ARE: ONE PLACE (X.X) = ± 0.060 TWO PLACE (X.XX) = ± 0.020 THREE PLACE (X.XXX) = ± 0.005 ANGULAR = ± 1°				
<b>PROPRIETARY AND CONFIDENTIAL</b> THE INFORMATION CONTAINED IN THIS DRAWING IS THE SOLE PROPERTY OF ROADRUNNER EQUIPMENT. ANY REPRODUCTION IN PART OR AS A WHOLE WITHOUT WRITTEN PERMISSION IS PROHIBITED.		VENDOR		SIZE
		MATERIAL		<b>B</b> PART NO.
		WEIGHT (LBS)	3.49	Wiring, Valve Assembly
				SCALE: 1:1
				SHEET 2 OF 2